

For Lease

Midway Distribution Center
2075-2085 Ellis Ave
St. Paul, Minnesota

- 251,732 total square foot building
- 25,200 square feet available
- 28' clear height
- ESFR Sprinkler
- 3 docks
- 30' x 40' column spacing
- Ample trailer and car parking
- Immediate access to I-94
- Newly repainted interior
- Rail served
- Quality high-clear distribution/warehouse space



For more information contact:

Steven T. Nilsson, CCIM
952.897.7899
snilsson@welshco.com

Peter H. Mork, J.D.
952.897.7772
pmork@welshco.com

Jason W. Simek
952.897.7898
jsimek@welshco.com

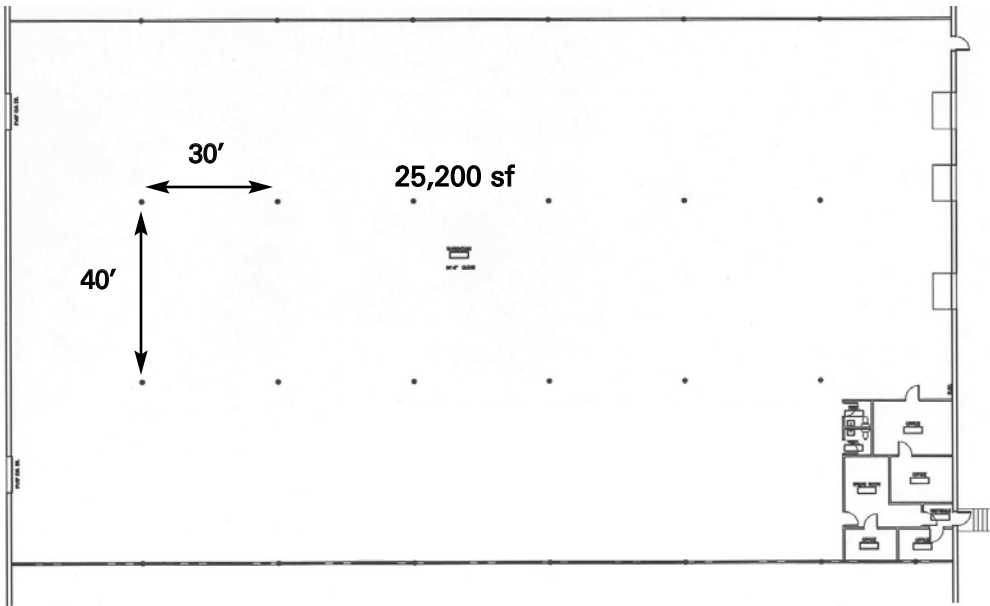

For more information contact:

Steven T. Nilsson, CCIM
952.897.7899
snilsson@welshco.com

Peter H. Mork, J.D.
952.897.7772
pmork@welshco.com

Jason W. Simek
952.897.7898
jsimek@welshco.com



Midway Distribution Center

2075-2085 Ellis Avenue
St. Paul, MN
For Lease

Building Address:	2075-2085 Ellis Avenue St. Paul, MN	Steven T. Nilsson, CCIM <ul style="list-style-type: none">• 952.897.7899• snilsson@welshco.com
Building Square Feet:	251,732 square feet total	
Available:	25,200 square feet total 888 square feet of office 24,312 square feet of warehouse	Peter H. Mork, J.D. <ul style="list-style-type: none">• 952.897.7772• pmork@welshco.com
Ceiling Height:	28' clear	Jason W. Simek <ul style="list-style-type: none">• 952.897.7898• jsimek@welshco.com
Sprinklers:	ESFR	
Loading:	3 docks	www.welshco.com
Columns:	30' x 40'	
Rental Rates:	\$3.85 psf gross warehouse \$7.85 psf gross office	900 Second Avenue South Minneapolis, MN 55402 Tel: 952.837.3000 Fax: 952.837.3001
Tax/CAM:	\$1.07 psf \$.54 psf \$1.61 psf total	

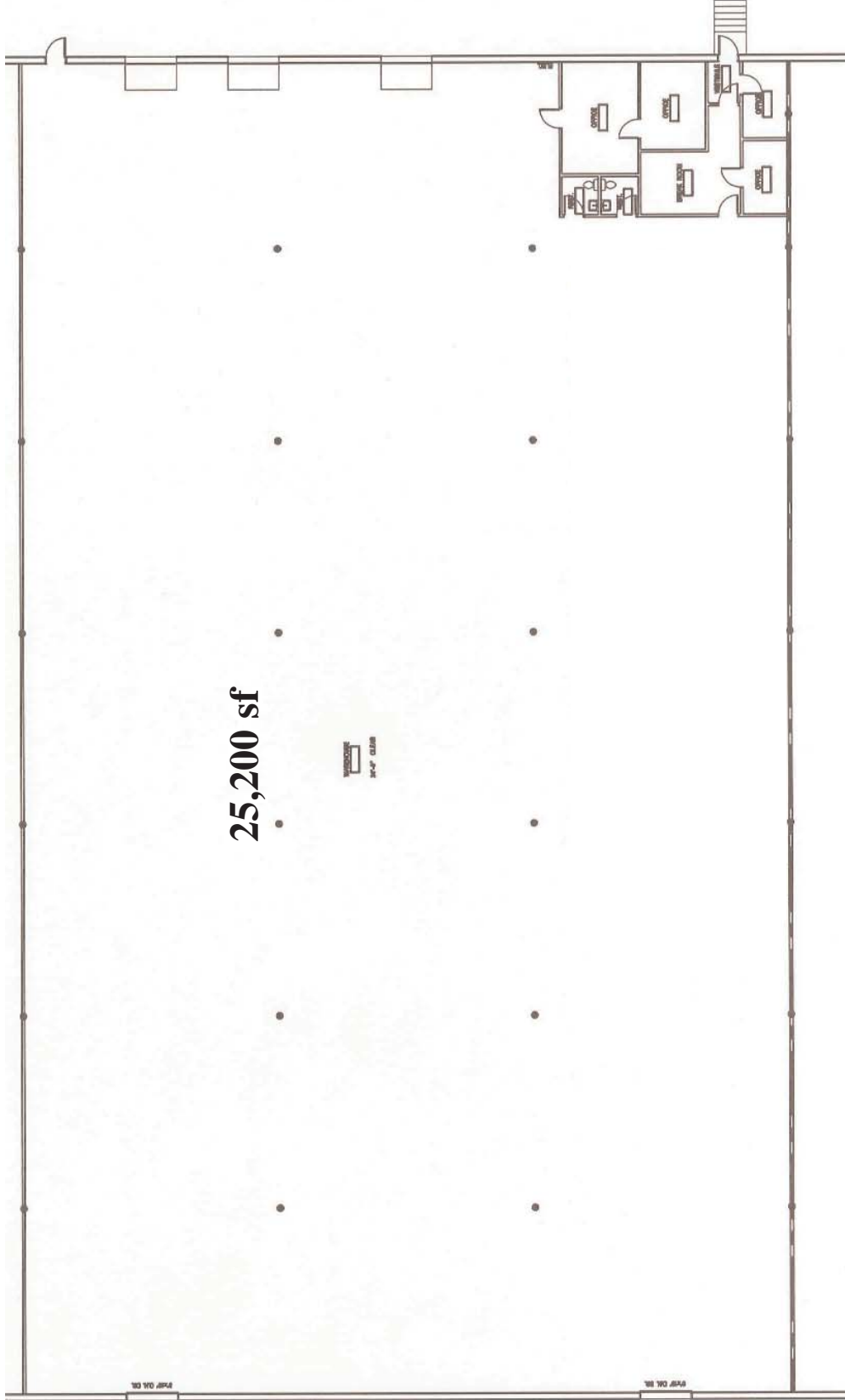

Midway Distribution Center
2075-2085 Ellis Avenue
St. Paul, MN